

PRODUCT DESCRIPTION

The information contained in the description applies to the **PK-4 system** (a set of TPK-4 and OPK-4 profiles, and the PK-4 mounting bracket)

- Easy LED service (assembly and disassembly OPK-4 extrusion „on click”)
- Line of light in the built-in lighting fixture without visible aluminum elements
- Can build fixtures going seamlessly from built-in to suspended ones
- Smoothly changing lighting height
- Fits in the thickness of a drywall board (12mm)
- Lighting fixtures can be combined to form lighting strings (ZM connectors)

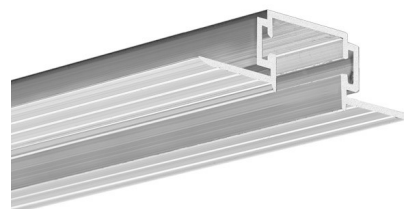

FINISH :

Non anodized (raw) 

*Custom colors available upon request

Fill empty fields

Product nr.

Fixture type

Company

Job name

Date

TECHNICAL SPECIFICATION

Application

- for creating serviceable straight- and broken-line fixtures, built into drywall, flush with their surface, without visible aluminum flanges

Assembly

- the technical strip is mounted with elastic adhesives, used in drywall techniques, and the OPK-4 lighting fixture is snapped in with a mounting bracket
- it is recommended that you use 2 mounting brackets for 1 running meter, 3 mounting brackets for 2 running meters, 4 mounting brackets for 3 running meters. With lighting fixtures shorter than 1 m, use at least 2 mounting brackets

Additional information

- it replaces the old TE-4 system
- it is fitted with a mounting bracket and the TPK-4 protective insert, which protects essential elements against soiling during assembly

AVAILABLE LENGTHS

Ref. nr.	surface finish	available lengths
18044NA_1	Non anodized (raw)	1000 mm
18044NA_2	Non anodized (raw)	2000 mm
18044NA_3	Non anodized (raw)	3000 mm

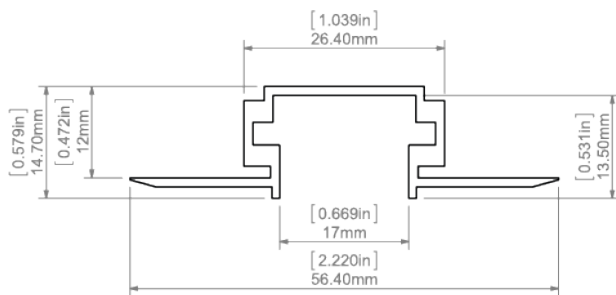
TECHNICAL DRAWING

RELATED PROFILES

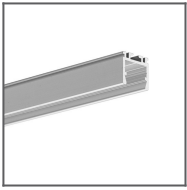

OPK-4 Profile
Ref: C0370

RELATED PRODUCTS

END CAPS

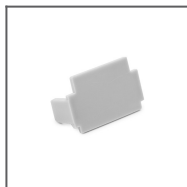

TPK-4 grey End cap
Ref: 24239

ACCESSORIES



6x1,2 Gland
Ref: 00802

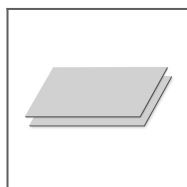

PK-4 Disassembly plates
Ref: 70261

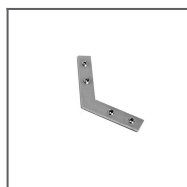

ZM-NA-120 Connector
Ref: 42729

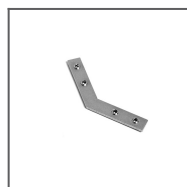

ZM-NA-135 Connector
Ref: 42725

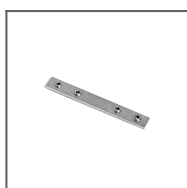

ZM-NA-180 Connector
Ref: 42724

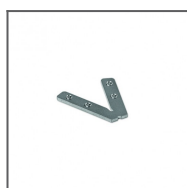

ZM-NA-45 Connector
Ref: 42339

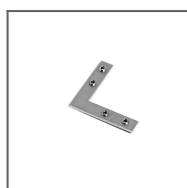

ZM-NA-90 Connector
Ref: 42723

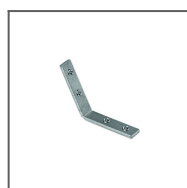

ZM-NA-PION-120 Connector
Ref: 42321

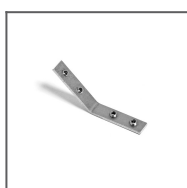

ZM-NA-PION-135 Connector
Ref: 42727



ZM-NA-PION-45 Connector
Ref: 42315

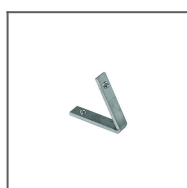

ZM-NA-PION-60 Connector
Ref: 42317

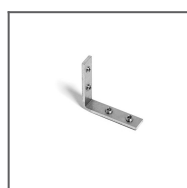

ZM-NA-PION-90 Connector
Ref: 42726

MARKETING MATERIALS



Foam 70267
Ref: 70267



PK-4 two-display installation
Ref: 90148



Presentation set 6
Ref: 90125