

PRODUCT DESCRIPTION

The hanger consists of two pieces with holes. Both parts should be inserted into the guide (small lock) of the selected extrusion. After insertion, they form a hanger that can be used to suspend the lighting fixture, by pulling e.g. a steel cable through it. To prevent the halves from moving in the guide, use the ZM BLOCK

Fill empty fields

Product nr.

Fixture type

Company

Job name

Date

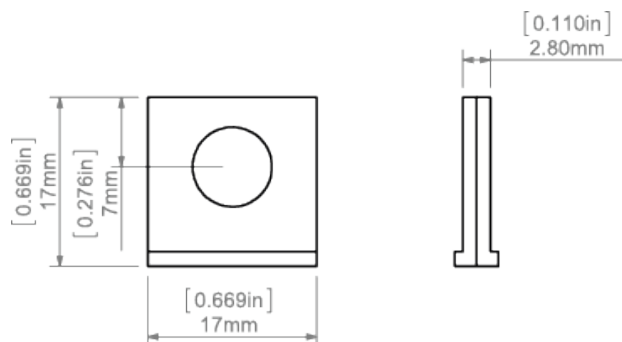
**TECHNICAL SPECIFICATION****TECHNICAL DRAWING**

RELATED PROFILES

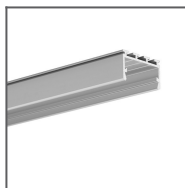

GIZA-LL profile
Ref: C0758

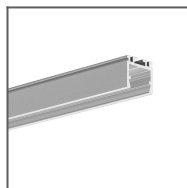

OPK-4 Profile
Ref: C0370

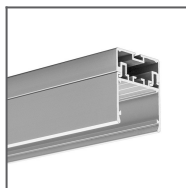

3035 Profile
Ref: 18039



JAZ Profile
Ref: B8547

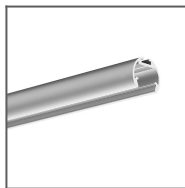

OLEK Profile
Ref: B8505



PDS-ZM Profile
Ref: B7696

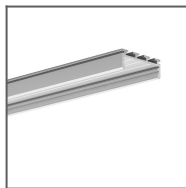

GIZA Profile
Ref: B5556

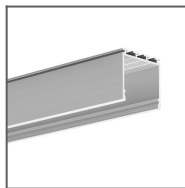

LIPOD Profile
Ref: B5554

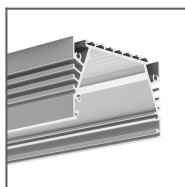

SEPOD Profile
Ref: B6593

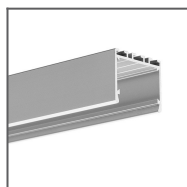

3035-O Profile
Ref: B8441

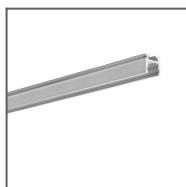

PIKO-ZM Profile
Ref: C1168

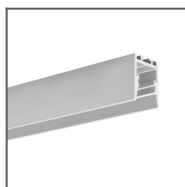

PDS-ZMG Profile
Ref: C1418

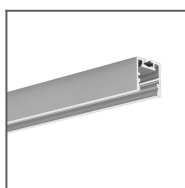

PDS-ZM-PLUS
Profile
Ref: C2056

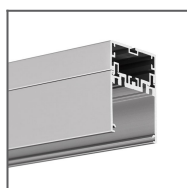

4050 Profile
Ref: 18050

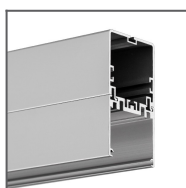

4050-W Profile
Ref: 18051

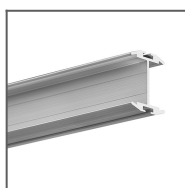

GIZA-DUO-LL
Profile
Ref: C2162

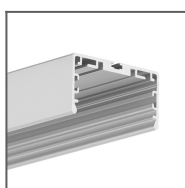

LIPOD-50 Profile
Ref: C2609

RELATED PRODUCTS

ACCESSORIES



Steel wire FI-1 1m
Ref: 1397

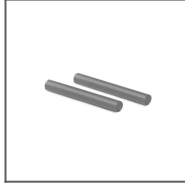

ZM Block
Ref: 42520