

## PRODUCT DESCRIPTION

- Designed to obtain an IP66, IP67 or IP68 waterproof rating
- Designed to reach IK10 degree of protection against mechanical impact
- Resistant to pedestrian and road traffic

### FINISH :

Non anodized (raw) 

Silver anodized 

\*Custom colors available upon request



Fill empty fields

Product nr.

Fixture type

Company

Job name

Date

## TECHNICAL SPECIFICATION

### Application

- construction of watertight, ground lighting fixtures inside and outside buildings (walkways, car parks, driveways)

### Assembly

- mounted on spacer foam in a prepared gap in the hardened surface (e.g. paving stones)
- the remaining gap is filled with sand

### Additional information

- possibility of making a linear fixture with IP67 protection, which means the fixture is dustproof and waterproof. Achieving IP67 is possible with the HR-LINE cover and the HR-LINE/HR-LINE-OTW end caps
- possibility of making a linear fixture with IP66 protection, which means the fixture is waterproof in contact with strong water jets. Achieving IP66 is possible with the HR-LINE-2 cover and the HR-LINE-STN end caps
- possibility of making a linear fixture with IP68 protection, which means the fixture is dustproof and waterproof - also under pressure. It stays functional when continuously submerged up to 3m. Achieving IP68 is possible with the HR-LINE-2 cover and the HR-LINE-STN end caps
- possibility of making a linear fixture with IK10 degree of protection against mechanical impact, which means that the fixture can withstand an impact of a 5kg weight dropped from a 40cm height with 20J energy. IK10 can be obtained with the HR-LINE-2 cover and the HR-LINE-STN end caps - dedicated glands must be used for the correct application of the profile
- water-tight splitters and couplers are used to run the cables powering the light fixture in the ground
- spece for LED strip: 12.2 mm

**AVAILABLE LENGTHS**

Ref. nr.	surface finish	available lengths
B3579NA_1	Non anodized (raw)	1000 mm
B3579NA_2	Non anodized (raw)	2000 mm
B3579NA_3	Non anodized (raw)	3000 mm
B3579ANODA_1	Silver anodized	1000 mm
B3579ANODA_2	Silver anodized	2000 mm
B3579ANODA_3	Silver anodized	3000 mm

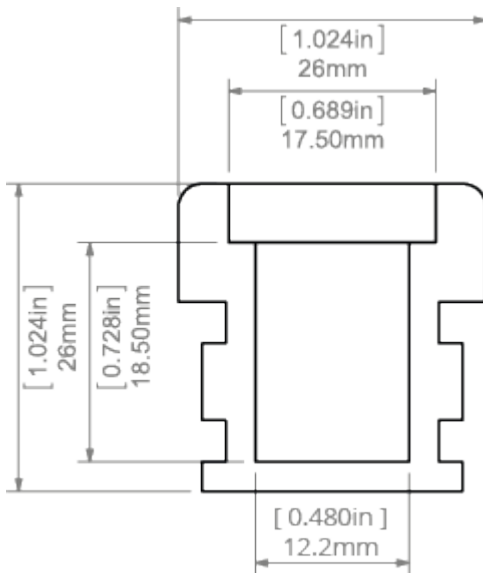
**TECHNICAL DRAWING**

## RELATED PRODUCTS

### COVERS

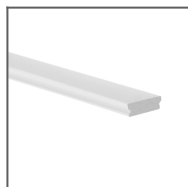

HR-LINE frosted Cover  
Ref: 1316

110°



HR-LINE-2 frosted Cover  
Ref: 17151

110°



### END CAPS

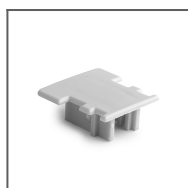

HR-LINE grey End cap  
Ref: 1384

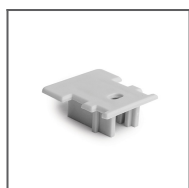

HR-LINE-OTW grey End cap  
Ref: 1445



HR-LINE-STN End cap  
Ref: 24199

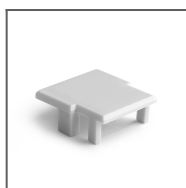

HR-LINE-Z grey End cap  
Ref: 00301

### ACCESSORIES



Hermetic coupler  
Ref: 42702



Hermetic splitter  
Ref: 42703



M16X1,5 Gland  
Ref: 00078

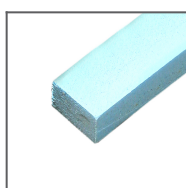

Pad for HR - LINE profile  
Ref: 1466

### MARKETING MATERIALS



Presentation set 1  
Ref: 90051

LED TAPES

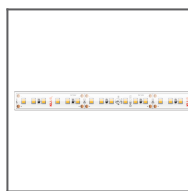

LED strip LED WP-K-1220-24V 9.6W/m  
Ref: WP-K-1220-24V

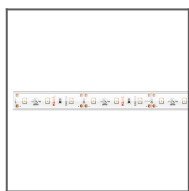

LED strip WP-K-1210-12V 4.8W/m  
Ref: WP-K-1210-12V

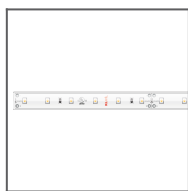

LED strip WP-K-1210-24V 4.8W/m  
Ref: WP-K-1210-24V



LED strip WP-K-1220-IP65-12V 9.6W/m  
Ref: WP-K-1220-IP65-12V



LED strip WP-K-1220-IP65-24V 9.6W/m  
Ref: WP-K-1220-IP65-24V



Taśma LED WP-K-1220-12V 9.6W/m  
Ref: WP-K-1220-12V

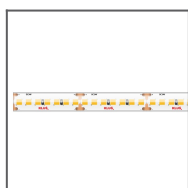

Taśma LED WP-K-1910-HD-IP65-24V 9.1W/m  
Ref: WP-K-1910-HD-IP65-24V