

PRODUCT DESCRIPTION

- Designed to reach an IP67 waterproof rating
- Minimum width and length
- Narrow line of light

FINISH :

Silver anodized ☐

*Custom colors available upon request



Fill empty fields

Product nr.

Fixture type

Company

Job name

Date

TECHNICAL SPECIFICATION

Application

The profile is designed for use in gaps of various materials with small cross-sections. It can be mounted to the edge of thin planes, glass, plastics etc. used in the furniture, exhibition, stage design, interior design, vehicles, etc.

Assembly

- with fixing glues, professional double-sided adhesive tapes

Additional information

- possibility of making a linear fixture with IP67 protection, which means the fixture is dustproof and waterproof
- frosted covers (diffusers) and aluminum-colored plastic end caps are available for this extrusion
- fast and reliable installation of sealed LED strips "5-KLIK" (LED strip in a special silicone sleeve ensuring increased tightness)
- ideal for use in bathrooms and other rooms with high humidity
- space for LED strip: 7.2 mm

Profile bending

Minimum internal radius	Minimum external radius
150 mm	150 mm

- minimum radius - bending radius which when exceeded causes destruction (deformation, bending or lack of compatibility with other accessories, e.g. covers, end caps, etc.) of the profile
- internal radius - refers to the profile bent so that the cover is facing the inside of the arch
- external radius - refers to the profile bent so that the cover is facing the outside of the arch
- irregular curves are possible after consultation and individual quotation

- when bending anodized profiles, one should be aware of cracking of the anode coating (which may be more or less visible depending on the radius)

AVAILABLE LENGTHS

Ref. nr.	surface finish	available lengths
B8288ANODA_1	Silver anodized	1000 mm
B8288ANODA_2	Silver anodized	2000 mm
B8288ANODA_3	Silver anodized	3000 mm

TECHNICAL DRAWING

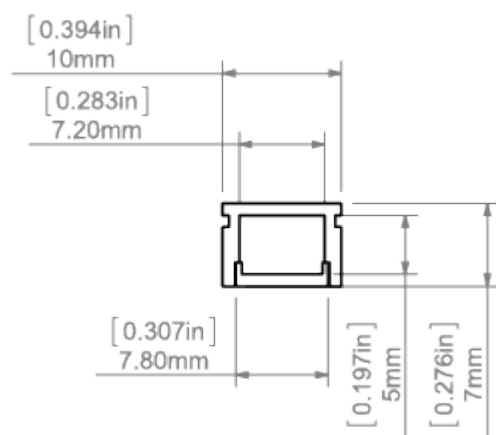

RELATED PRODUCTS

COVERS



PIKO frosted Cover
Ref: 17034

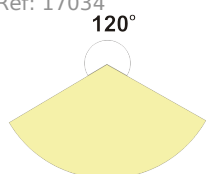

END CAPS

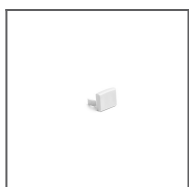

PIKO grey End
cap
Ref: 24202

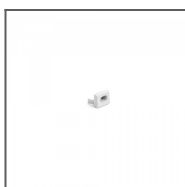

PIKO-OTW grey
End cap
Ref: 24299

ACCESSORIES



6x1,2 Gland
Ref: 00802

MARKETING MATERIALS



Display
P230-90107M
Ref: 90107M



Display
P230-90172M
Ref: 90172M

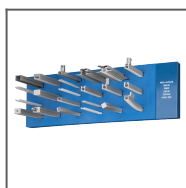

Foam 70341
Ref: 70341



Presentation set 6
Ref: 90125

LED TAPES



LED strip 5K-WP-
K-1091-24V
9.1W/m
Ref: 5K-WP-
K-1091-24V

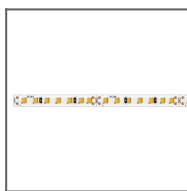

LED strip
K-1091-24V
9.1W/m
Ref: K-1091-24V