

Profile DIPOK-US

Ref. H1233

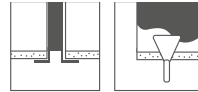
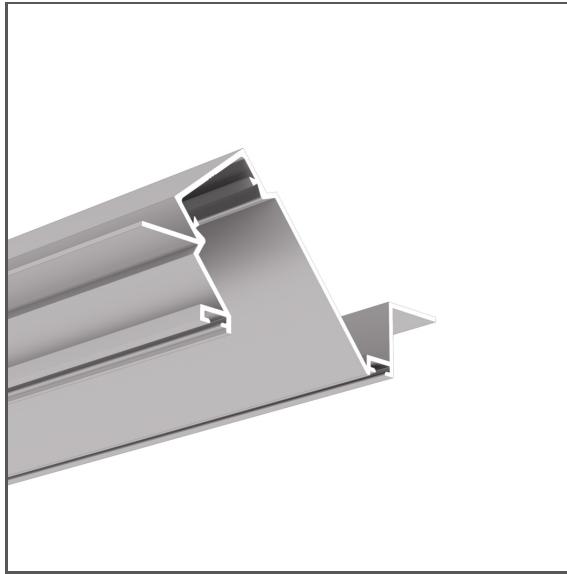

- Linear gallery, stage or exhibition lighting
- The lighting fixture integrates with the mounting surface
- Hidden light source
- Lighting angle: 50 Degrees
- Mounting to 16 mm | 0.63" drywall
- Stable mounting to a suspended ceiling

APPLICATION

- decorative lighting and functional

MONTAGE

- in drywall, with screws
- can be easily connected into runs

ADDITIONAL INFORMATION

- in order to protect the lighting fixture during installation, a TECH-22 protective insert should be used

TECHNICAL DRAWING

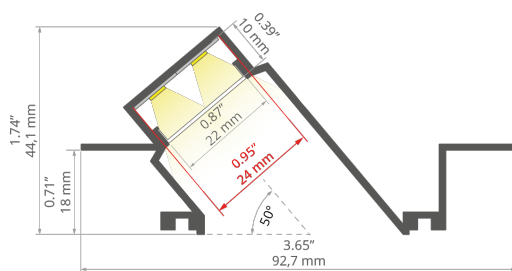





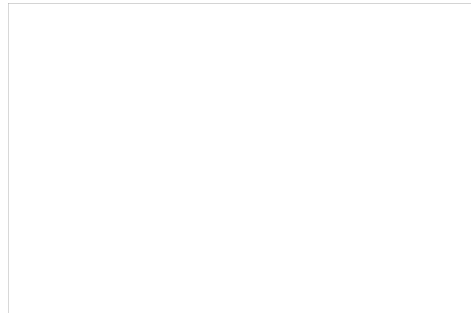
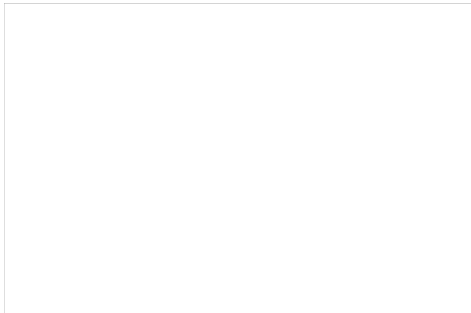

TECHNICAL SPECIFICATIONS

Material	aluminum	Color	Length	Ref
Lighting at an angle	50	□ white lacquered	2005 mm	H1233L9010OD_2
LED gluing width A	22 mm		3010 mm	H1233L9010OD_3
Number of LED strips A (8 mm wide)	2	non anodized	1000 mm	H1233NA_1
The cover is cut to the length of the profile	yes		2005 mm	H1233NA_2
Can be easily connected into runs	yes		3010 mm	H1233NA_3
Decorative lighting	yes			
Functional lighting	yes			
Mounting to drywall	yes			
Possibility of obtaining a line of light	yes			
To cover with plaster	yes			
Wire out back of extrusion	yes			



SAMPLE PROJECTS



COVERS

NAME	MATERIAL	MATERIAL TRANSMITTANCE	COLOR	REF.
MUN-22	PC	86 %	 semi-transparent	17042
HS-22	PC	73 %	 frosted	17011
		94 %	 clear	17022
LIGER-22	PC	62 %	 frosted	17032V1
		39 %	 black	17087
DILENSO	PC		 clear	17173

END CAPS

NAME	MATERIAL	COLOR	REF.
DIPOKET	PP	 gray	24461
		 white	24462

OTHER ACCESSORIES



CONNECTOR
ZM-NA-60
42305



CONNECTOR
ZM-NA-PION-45
42315

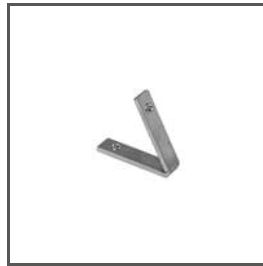

CONNECTOR
ZM-NA-PION-60
42317

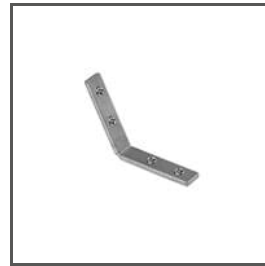

CONNECTOR
ZM-NA-PION-120
42321



CONNECTOR
ZM-NA-45
42339



CONNECTOR
ZM-NA-90
42723



CONNECTOR
ZM-NA-180
42724



CONNECTOR
ZM-NA-135
42725

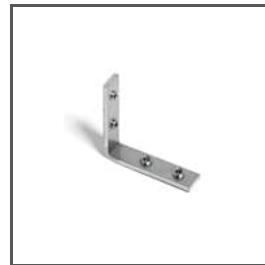

CONNECTOR
ZM-NA-PION-90
42726



CONNECTOR
ZM-NA-PION-135
42727



CONNECTOR
ZM-NA-120
42729